

pneumatic cutting forming machine for taped radial components

TP R-PR

macchina pneumatica taglia forma componenti radiali nastrati



LUNG. = 24 cm
LARGH. = 22 cm
ALT. = 24 cm
IMBALLO = 41x53x32 cm
VOLUME = 0,069 m³
PESO MACCHINA = 10 kg
PESO LORDO = 12 kg

LENGTH = 24 cm
WIDTH = 22 cm
HEIGHT = 24 cm
PACKING = 41x53x32 cm
VOLUME = 0,069 m³
MACHINE WEIGHT = 10 kg
GROSS WEIGHT = 12 kg



SMS preforming assembly (see next page) for the TP/R-PR machine. SMS is not included in the machine price and needs to be ordered separately.

SMS gruppo di preformatura (vedi pag. successiva) che deve essere sempre ordinato con la macchina TP/R-PR non incluso nel costo della macchina

TP/R-PR cod. 90.0000
Manual version - Versione manuale

The model TP/R-PR is a pneumatic machine with foot pedal control designed for cutting and forming taped radial components. The tape is manually fed into the die and position is easily adjusted. The die assembly "SMS" is equipped with a wire holder to keep the leads firm in position during the machine operation avoiding any stress or damage to the part. Changing the "SMS" is very quick and easy.

Il modello TP/R-PR è una macchina pneumatica con comando a pedale per il taglio e la preformatura di componenti radiali nastrati. Il nastro è alimentato manualmente all'interno della matrice e la sua posizione è impostata facilmente. Il gruppo di preformatura "SMS" è sempre fornito con premi-filo per mantenere i reofori nella corretta posizione durante la lavorazione della macchina in modo da evitare stress o danni al componente. La sostituzione dell'"SMS", per variare la forma, richiede pochi minuti.

optional accessories

accessori opzionali



AS1
COMPLETE WITH PLATE, DRIVING WHEELS
AND SUPPORT FOR TAPE AND REEL.
(Cod. 95.OL11 = 110V - 95.OL12 = 220V)

COMPLETO DI PIASTRA, ANELLI DI
TRASCINAMENTO E SUPPORTO PER
NASTRO IN BOBINA

TP/R-PR with SMS and AS1
automatic feeding system
TP/R-PR con SMS e AS1
sistema automatico di alimenta-
zione

The AS1 is a feeding system designed for the TP/R-PR machine. It allows to reach higher production. It can be supplied to adapt to the two most common component tape hole pitches: 12,7 mm (.5") code 95.OL11 for 110 v and 95.OL12 for 220 v or 15 mm (.59") code 95.OL13 for 110 v and 95.OL14 for 220 v.

L'AS1 è un sistema automatico adattabile solo alla TP/R-PR. Questa attrezzatura consente alla macchina di effettuare una maggiore produzione. Può essere fornito in due versioni per lavorare i due più comuni passi di nastratura e cioè: 12,7 mm cod. 95.OL12 oppure 15 mm cod. 95.OL14.

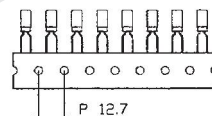
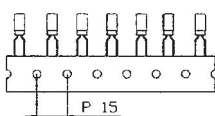

PRODUCTION ON TP/R-PR = 7000 p/h
ELECT. SUPPLY = 220 or 110V - 50 Hz - 100 VA
LENGTH = 50 cm
WIDTH = 60 cm
HEIGHT = 18 cm
PACKING = 60x60x30 cm
VOLUME = 0,108 m³
NET WEIGHT = 15 kg
GROSS WEIGHT = 18 kg

PRODUZIONE SU TP/R-PR = 7.000 p/h
ALIMENTAZIONE = 220V - 50 Hz - 100VA
LUNG. = 50 cm
LARGH. = 60 cm
ALT. = 18 cm
IMBALLO = 60x60x30 cm
VOLUME = 0,108 m³
PESO NETTO = 15 kg
PESO LORDO = 18 kg

standard SMS die assemblies for TP/R-PR machine

SMS gruppi standard di preformatura per macchina TP/R-PR

SMS/1 STAND OFF- LOCK IN
SMS/1 DOPPIA ANSA
(Cod. 93.0001)

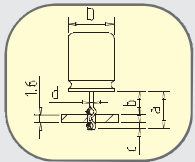

	MM			IN		
	min	max	fix	min	max	fix
a	6	13		.236	.511	
b	3	10		.118	.393	
c			1,4			.055
d	0,4	0,8		.015	.031	
D	1	10		.039	.393	

SMS/6 90° BENDING
SMS/6 PIEGA A 90°
(Cod. 93.0006)

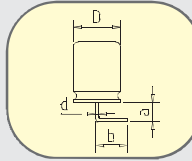

	MM			IN		
	min	max	fix	min	max	fix
a	3	8		.118	.314	
b*			6			.236
d*	0,4	0,8		.015	.031	
D*	1	6		.039	.236	

SMS/2 STAND OFF
SMS/2 ANSA IN APPOGGIO
(Cod. 93.0002)

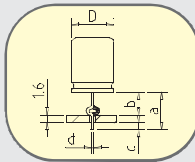

	MM			IN		
	min	max	fix	min	max	fix
a	6	13		.236	.511	
b	3	10		.118	.393	
c			1,4			.055
d	0,4	0,8		.015	.031	
D	1	10		.039	.393	

SMS/7 SURFACE MOUNTING
SMS/7 MONTAGGIO IN SUPERFICIE
(Cod. 93.0007)

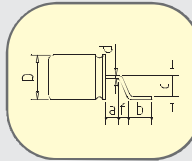

	MM			IN		
	min	max	fix	min	max	fix
a	2,5	8		.098	.314	
b*			2			.078
c*			2,5			.098
d*	0,4	0,8		.015	.031	
D*	1	10		.039	.393	
f*			1			.039

SMS/3 BODY LOCKED ON P.C.BOARD
SMS/3 ANSA A BLOCCAGGIO CON CORPO A BATTUTA
(Cod. 93.0003)

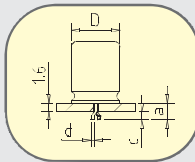

	MM			IN		
	min	max	fix	min	max	fix
a			3			.118
c			1,4			.055
d*	0,4	0,8		.015	.031	
D	1	10		.039	.393	

SMS/8 TO92 CENTER LEAD SPREAD P.1,27 AND CUT
SMS/8 TO92 REOFORO CENTRALE SPOSTATO P.1,27
(Cod. 93.0008)

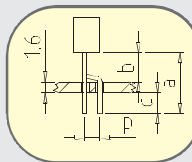

	MM			IN		
	min	max	fix	min	max	fix
a	6	9		.236	.354	
b	3	6		.118	.236	
c			1,4			.055
p*			1,27			.05

SMS/4 STRAIGHT CUT
SMS/4 SOLO TAGLIO
(Cod. 93.0004)

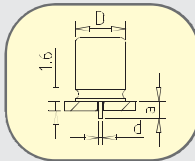

	MM			IN		
	min	max	fix	min	max	fix
a	3	10		.118	.393	
d	0,4	0,8		.015	.031	
D	1	10		.039	.393	

SMS/10 TO92 CENTER LEAD SPREAD AND LOCK
SMS/10 TO92 REOFORO CENTRALE SPOSTATO CON
ANSA A BLOCCAGGIO
(Cod. 93.0010)

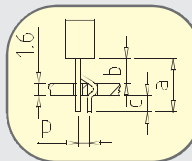

	MM			IN		
	min	max	fix	min	max	fix
a	6	9		.236	.354	
b	3	6		.118	.236	
c			1,4			.055
p*			1,27			.05

SMS/5 POLARITY
SMS/5 POLARITA'
(Cod. 93.0005)

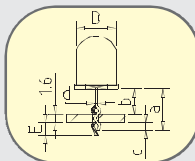

	MM			IN		
	min	max	fix	min	max	fix
a	6	13		.236	.511	
b	3	10		.118	.393	
c			1,4			.055
d*	0,4	0,8		.015	.031	
D	1	10		.039	.393	
E*			2,2			.086

SMS/11 TO92 CENTER LEAD SPREAD 3 LEAD LOCK
SMS/11 TO92 REOFORO CENTRALE SPOSTATO E DOPPIA ANSA SU TRE REOFORI
(Cod. 93.0011)

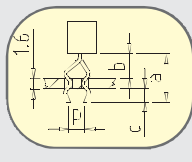

	MM			IN		
	min	max	fix	min	max	fix
a	6	9		.236	.354	
b	3	6		.118	.236	
c			1,4			.055
p*			1,27			.05

*= quote to be specified upon order
*= quota da comunicare all'ordine

Forms realised
with special SMS

Forme realizzate
con SMS speciali

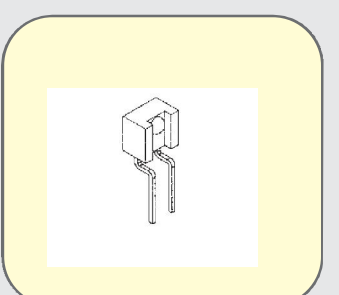
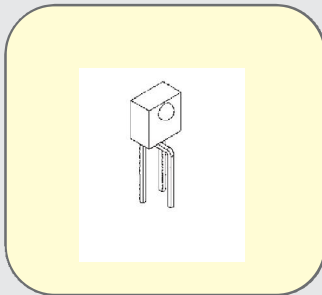
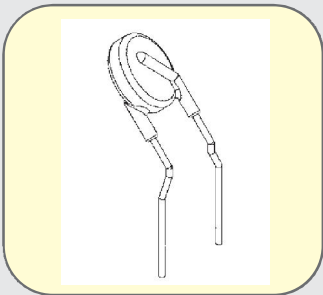
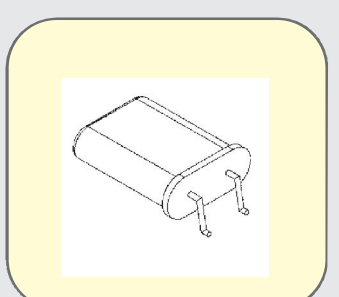
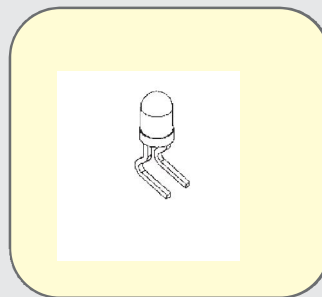
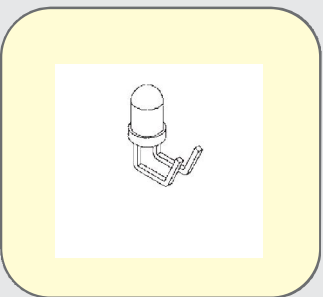
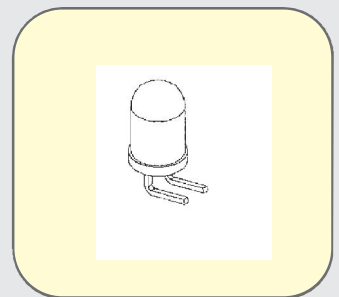
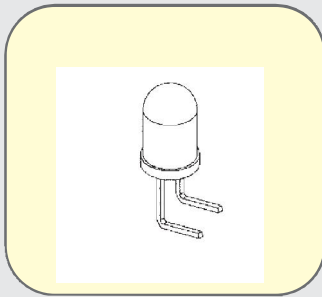
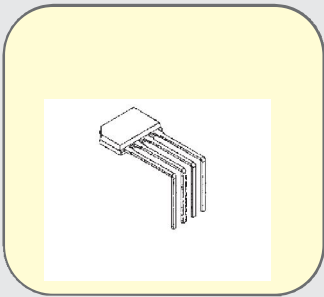
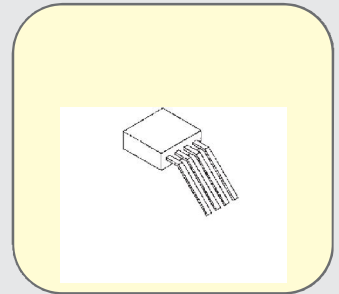
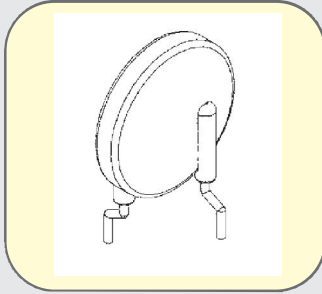
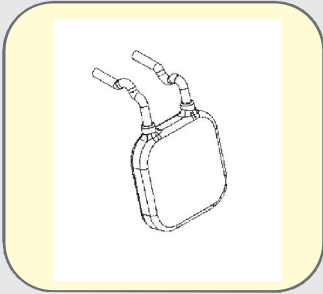
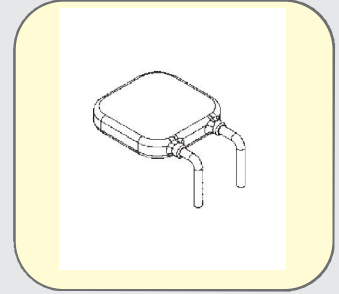
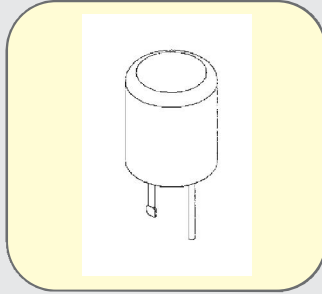
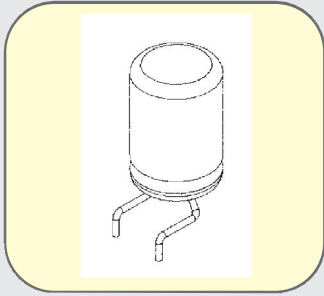

We are always designing more and more new forms in order to satisfy the always increasing customer request for special applications.

Progettiamo sempre molte nuove forme per soddisfare la crescente esigenza di applicazioni speciali.